

POWER STATION

HPS-300/600/1100/1600

For Your Safety

Read and understand this manual before use.
Keep this manual for future reference.

HPS-300/600/1100/1600

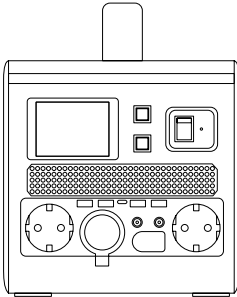

We are still constantly improving this power station, therefore, some parts of this power station may be changed in order to achieve the better quality, but the main functions and operations will not be alternated and changed. Your understanding would be greatly appreciated.

Table of Contents

SAFETY	2
GENERAL DESCRIPTION	3
MAIN PARAMETERS	4
OPERATION CONTROL AND DESCRIPTION	5
OPERATION	6
STORAGE AND DOWNTIME MAINTENANCE	10

1. SAFETY

Please pay attention to the following before using this product, otherwise it may damage your electronic devices or cause a danger. To avoid fire or electrical shock hazard, observe all ratings on unit and products you intend to use.

- 1) Rechargeable Lithium-iron-phosphate (LiFePO₄) battery is equipped with this product so take particular attention on operation, storage and delivery.
- 2) Recharge only with the charger specified by the manufacturer. A non-specified charger may create a risk of fire.
- 3) Charge it in a ventilated location; do not put this product in water and do not throw or beat this product.
- 4) Keep this product and related accessories in a safe place, which is not accessible to children. Do not expose it to sources of ignition or other heat sources to avoid danger.
- 5) Avoid touching the charging/discharging socket with the metal objects. Otherwise will cause a short circuit and injured.
- 6) Inadequate ventilation may cause damage to the unit. Do not put anything on top of the unit.
- 7) Do not disassemble the appliance and do not use it when the temperature is above 40 degrees.
- 8) Inspect the unit for dirt, dust, or moisture on a regular basis.
- 9) Do not insert any objects into output port or ventilation holes.
- 10) Any repair must be carried out by the manufacturer or an authorized repair agent in order to avoid danger. Do not attempt to replace the internal battery. It shall be done by a qualified service center.
- 11) Do not insert any conductors into output port deliberately.

2. GENERAL DESCRIPTION

This power station is made of rechargeable Lithium-iron-phosphate (LiFePO4) battery, inverter circuit and battery management system (BMS). It supports AC&DC input charging by power source.

* Scope of application

USB Port: Smart phone, MP3 Player, Digital Camera, Tablet, E-reader, etc.

DC 12V Output Ports: LED lamp, etc.

DC 12V Cigarette Port: 12V appliances, etc.

AC Output Port: Electric appliances such as Televisions, Laptops, Cooker, etc.

* Electric appliances which you intend to use must be less than the device's continuous output power.
(HPS-300: 300W / HPS-600: 500W / HPS-1100: 1000W / HPS-1600: 1500W)

3. MAIN PARAMETERS

Model	HPS-300	HPS-600	HPS-1100	HPS-1600
Capacity	24Ah (12.8V)	20Ah (25.6V)	40.5Ah (25.6V)	58.5Ah (25.6V)
Battery type	Lithium-iron-phosphate (LiFePO4)			
AC output Port	230/240V, 50Hz, Pure sine wave output (2xAC Port)			
Continue power	300W	500W	1000W	1500W
Peak power	600W	1000W	2000W	3000W
4*USB output	5V/2A, 9V/2A, 12V/1.5A			
1*Type-C Port	5-20V, PD 60W Max	5-20V, PD 100W Max		
2*DC 12V Port	12V/5A			
EC5 port	DC12-14.4V 80A(MAX)	DC12.8V 10A		
1*DC 12V Cigarette plug	12V/10A			
Charging ways	Wall & solar charging			
Charging Input	DC 12-30V 120W (MAX) MPPT	DC 12-30V 200W (MAX) MPPT		
Operation temperature	0~45°C			
Product size (L*W*H mm)	250*190*230	250*190*230	385*190*230	480*190*230
Weight	6.7Kg	8.2Kg	14.9Kg	19.8Kg

* List of contents

Package	Color box
Power station	1EA
Exclusive charger	1EA
Instruction manual	1EA
Solar charger	Optional
Smart Jumper Clamp	Optional

4. OPERATION CONTROL AND DESCRIPTION

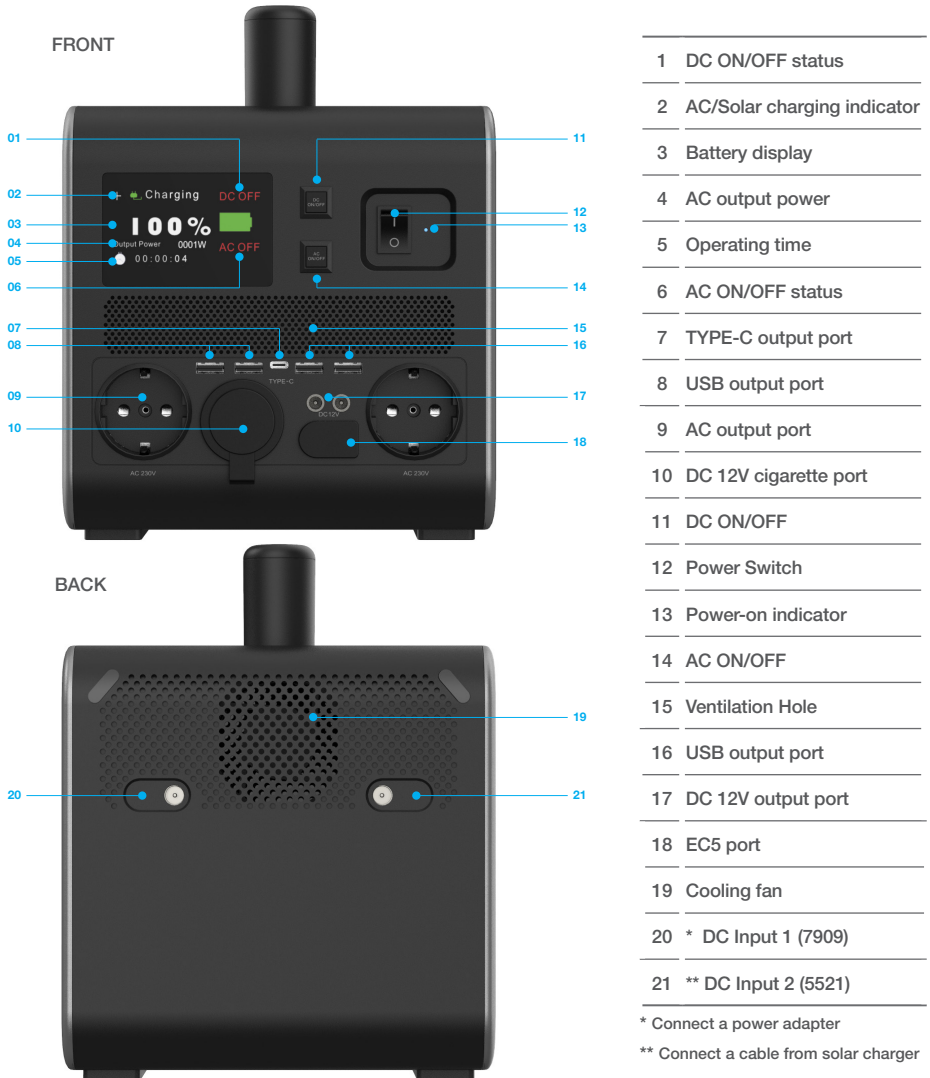

5. OPERATION

1) Using power station

- a. Press power switch (12) to turn on the power station, then LCD indicator (13) will be launched.
- b. Press AC ON/OFF (14) button to turn it on, AC ON character (6) will display.
- c. Connect one end of the cable to the AC socket (9) and the other end of it to your electric appliances after 3 seconds from AC function turned on.
- d. Press AC ON/OFF button (14) again to turn it off when you stop to use it, and AC OFF character (6) will display.
- e. Press DC ON/OFF button (11) to turn it on, DC character (1) will display.
- f. Connect one end of the cable to any DC port like USB-A (8), Type-C (7), DC round port (16) or car cigarette port (17), and connect the other end of cable to your mobile phone, Laptop, Drone or other digital electronic equipment.
- g. Press DC ON/OFF button (11) again to turn it off when you stop to use it, and DC OFF character (1) will display.

* How to know if your electronic devices will work with the power station?

First, you need to determine the amount of power your electronic device requires. This may require some research by yourself, examining the user guide for your electronic device should suffice. Second, you will need to check the capacity for the individual output ports. For example, the AC port of HPS-600 is monitored by an inverter that allows for 500W of continuous power. This means if your device is pulling more than 500W for an extended period of time, the portable power supply will shut off.



WARNING :

Please do not insert any conductors into output port deliberately.



NOTE:

1. When the power is lower than 1%, both AC and DC stop to work, turn off the power switch to protect batteries from being damaged by loss of power.
2. When the power is lower than or equal to 10%, the battery level symbol is turned to red from green.
3. When the power level is lower than or equal to 5%, the battery level symbol flashes in red.
4. If possible, keep your power station fully charged before long-term downtime. (Please fully recharge your power station in every 6 months at least for long-term usage)

2) Charging power station

a. Charging with AC cable (Max charging power : HPS-300 : 120W / HPS-600/1100/1600 : 200W)

Plug the charging cable into wall outlet, then connect the other side to the DC Input port 1 (20, DC 7909) of the power station, you can see the charging state from the LCD display (2).

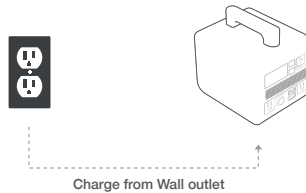

b. Charging with solar charger (Max charging power : HPS-300 : 120W / HPS-600/1100/1600 : 200W)

* Solar charger is optional

- Place your solar charger where it can get as much direct sunlight as possible.
- Connect the solar charger by solar charging cable, then insert the plug of the cable into the DC Input port 2 (21, DC 5521) on the back side of the portable power station. You can know the charging state from the LCD display (2).
- It will stop charging when the battery is full of energy.

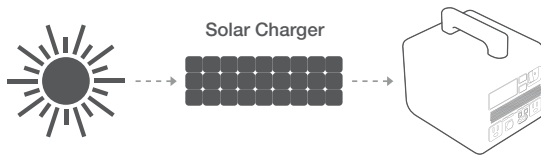

⚠ NOTE:

1. For wall charging, recharge only with the charger specified by the manufacturer.
2. Solar charging will be halted automatically for the protection of solar charger during the night when there is no light. In order to resume solar charging, please disconnect and re-connect the solar charger.
3. For solar charging, it is recommended to use HYUNDAI solar charger or unless must use solar charger as following specification.
 - a. Connector : DC 5521 male connector
 - b. Charging type
 - MPPT Charging type
 - DC output : 12~30V (Output voltage of 24V will be better)
4. Additional controllers are not required whether charging the power station by PWM or MPPT type solar charger.
5. AC charging and solar charging are not available at the same time.

3) EC5 Port

- a. The power station has enough power to assist start a vehicle's engine, while before using the EC5 , please make sure the remaining battery capacity is at least 60%.
- b. Connect the positive and negative polarities of the battery clamps to the positive and the negative polarities of car battery (Red to +, black to -).
- c. Turn the car key to start it up.
- d. Disconnect the clamps with battery and the jumping port of your power station.



NOTE:

Make sure the gas engine displacement of the vehicle is less than 4L.

1. Make sure the battery power is over 60%
2. Make sure the battery clamps is not broken.
3. Before starting, make sure the red and black clips are clamped tightly to the battery poles of your car, keep the two clips with enough safety distance, to prevent the two from falling off or collision because of the engine vibration after car starting.
4. It is strictly prohibited to connect the red and black clip directly, otherwise it may cause accidents.
5. Please keep away from the engine when starting the car to avoid any physical injury that may cause by car engine running.
6. Please remove the product from battery within 30 seconds after engine started, otherwise it might cause damage to the portable power supply or even cause accident
7. People who are not familiar with this product (especially children) is strictly prohibited to use this function.
8. Please remove all personal jewelry, such as rings, bracelets, necklaces, and watches before jump starting.

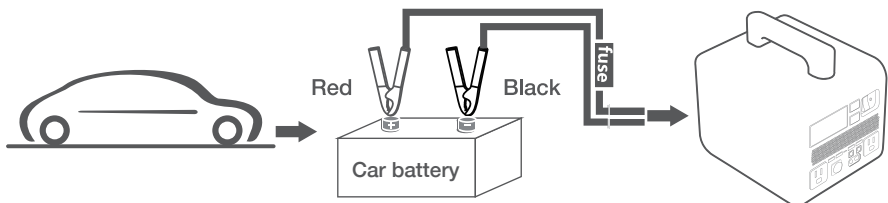

4) Alarm information description

a. Overload

When the using output power is more than specific output power which the model can be applied, the alarm area will display "OVERLOAD". It is necessary to reduce the power of the electronic devices. If the AC output is turned off at this time, Press the AC ON/OFF button again and restart.

b. High temperature

When the internal temperature is higher than 35 degrees Celsius or the output power is greater than 200W, the cooling fan starts to work. When the internal temperature is higher than 80 degrees Celsius, the temperature alarm starts. The AC and DC outputs are off and the alarm area shows "HI TEMP", which will stop working at once. You need to wait until the temperature drops below 40 degrees Celsius to restart.

6. STORAGE AND DOWNTIME MAINTENANCE

Failure to maintain your power station by following steps can result in battery damage.

1. Please charge your power station before storage and fully recharge it every 6 months at least.

Store it in a cool and dry place.

2. If the main power supply shuts down automatically because of lower battery capacity, please recharge it within 3 months. Otherwise, the battery capacity won't be recovered.



Cold temperatures (below freezing) can impact the battery capacity of the power station.

If you are living in sub-zero conditions, you can drain power from it. Never charge it in the sub-zero conditions, which will damage the lithium-ion battery and battery capacity may not be recovered



Correct Disposal of this product

This marking indicates that this product should not be disposed with other household wastes throughout the EU. To prevent possible harm to the environment or human health from uncontrolled waste disposal, recycle it responsibly to promote the sustainable reuse of material resources. To return your used device, please use the return and collection systems or contact the retailer where the product was purchased.

EC Declaration of Conformity



We :

HYUNDAI Corporation

25, Yulgok-ro 2-gil, Jongno-gu, Seoul 03143 Korea

Declare that the product detailed below :

POWER STATION

MODEL : HPS-300, HPS-600, HPS-1100, HPS-1600

Satisfies the requirements of the Council Directives :

Low voltage directive 2014/35/EU

Electromagnetic Compatibility 2014/30/EU

ROHS Directive 2011/65/EU & (EU) 2015/863

and conform with the norms :

EN 55032: 2015+A11: 2020

EN 55035: 2017+A11: 2020

EN 61000-3-2: 2019

EN 61000-3-3: 2013+A1: 2019

General Manager

A handwritten signature in black ink, appearing to be 'Inseok Jeong', written over a horizontal line.

Date : 2021.07.01

Inseok Jeong

HYUNDAI Corporation

25, Yulgok-ro 2-gil, Jongno-gu,

Seoul 03143, Korea,

Post Code : 03143

+ 82 2 390 1114

www.hyundaicorp.com

Copyright HYUNDAI Corporation All rights reserved.

Made in P.R.C

HYUNDAI